



PowerStep Installation Requirements

Power Requirements:

Three (3) separate 120 VAC, 20 amp circuits located behind each respective component

See plan layout drawing.

- Circuit for computer and controls
- Circuit for air compressor
- Circuit for treadmill

Equipment Layout Requirements:

- System requires a minimum of 9 feet 10 inches ceiling clearance within the area of the upper horizontal support beam.
- See plan layout drawing for all dimensions. (see below)

Delivered Items will include:

- Air Compressor: 1 piece, 30" x 30" skid, 45" high. DO NOT STACK other items on top of this skid. Weight: 350 pounds.
- Treadmill: 1 piece, 96" x 36" skid, 36" high. DO NOT STACK other items on top of this skid. Weight: 500 pounds.
- TheraStride Frame: 1 piece, 132" x 48" crate, 55" high. DO NOT STACK other items on top of this crate. Weight: 1375 pounds.

Material Handling:

Provisions should be made by the buyer to move the above items from the delivery location to the final assembly location. Buyer provisions are also required to dispose of the crates, skids and packaging materials after installation.

The buyer should make 2-3 individuals available to assist in positioning some portions of the assembly. These individuals must be capable of lifting or moving up to 100 pounds per person. Moving and lifting requirements will be for limited and brief periods of time.

PowerStep System

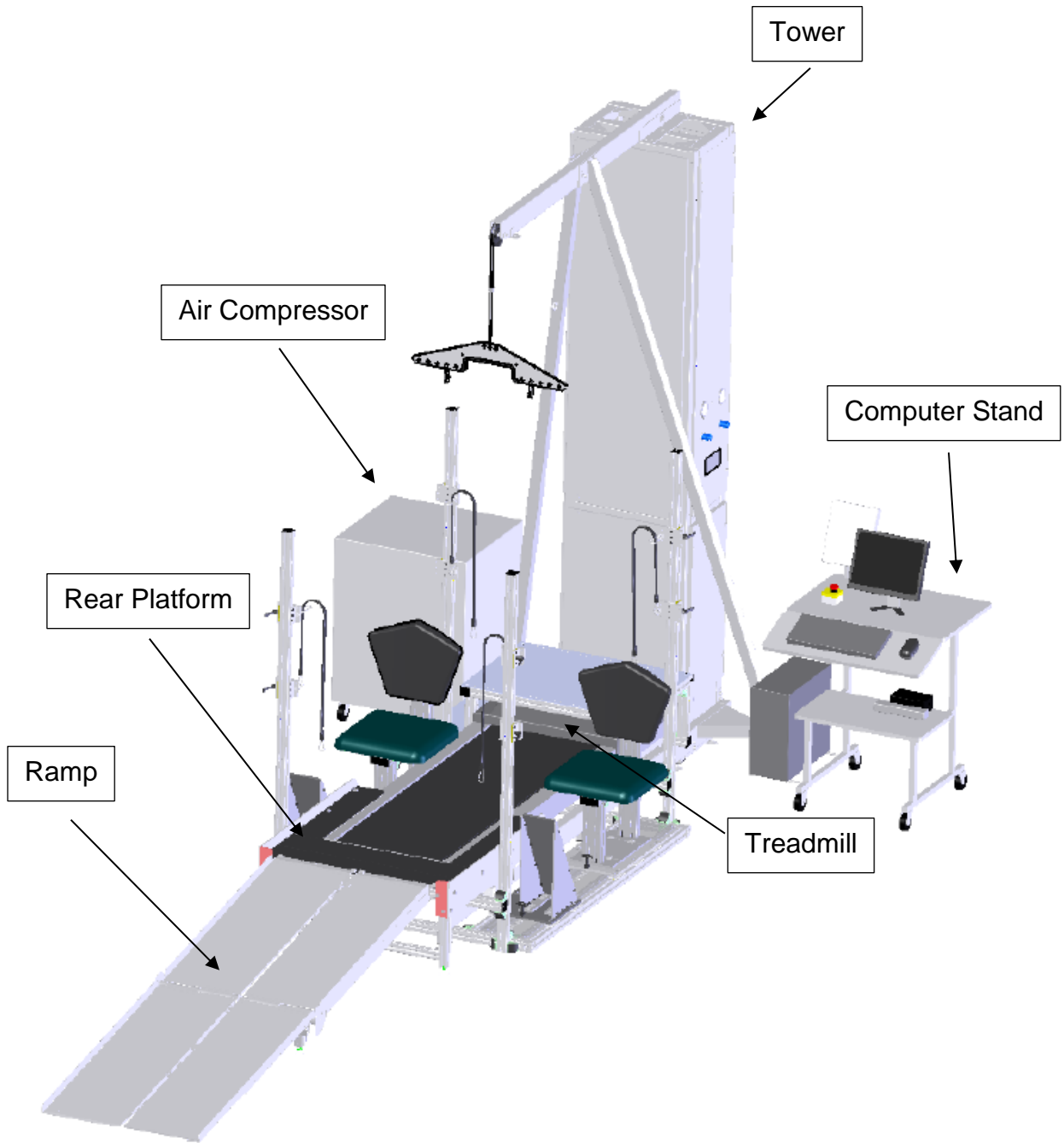

PowerStep Dimensions

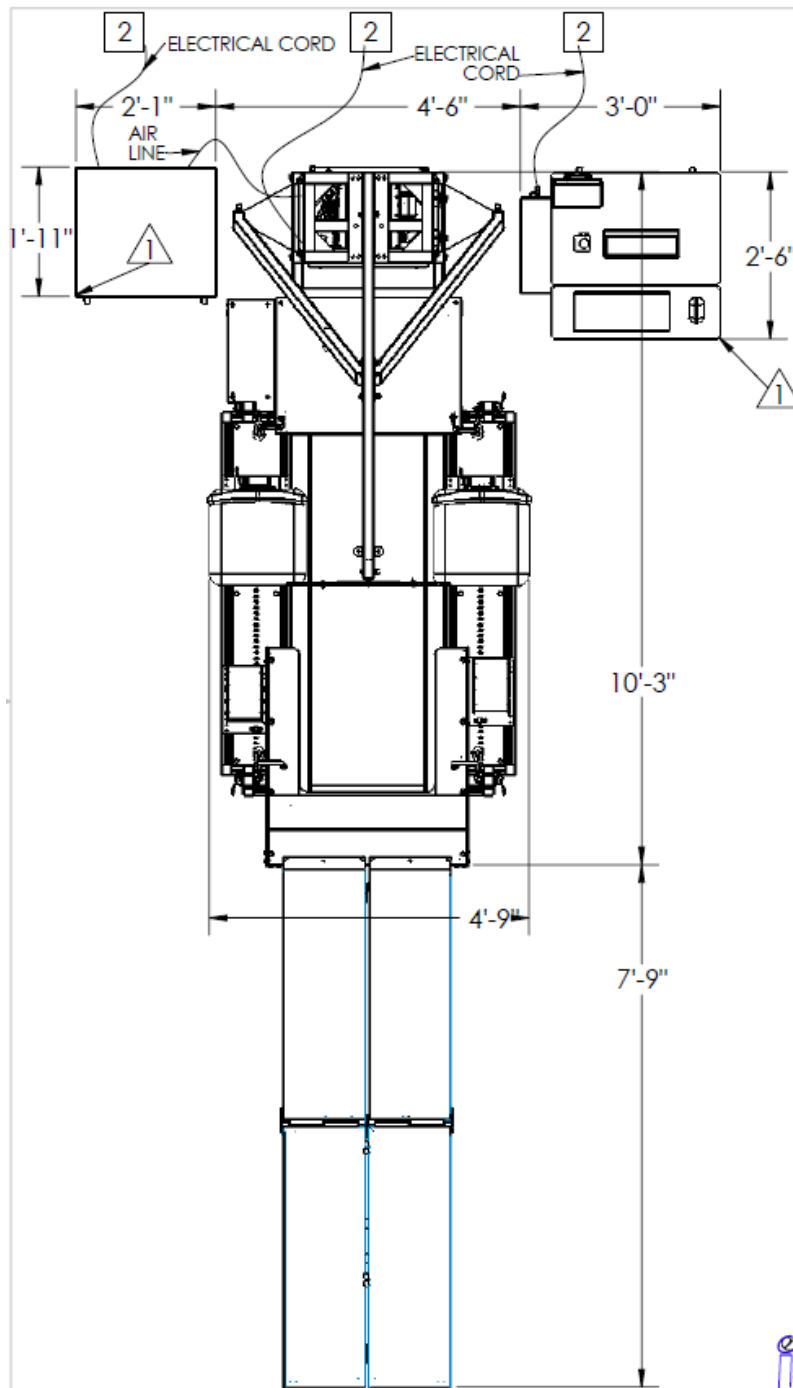

NOTES:

1 BOTH AIR COMPRESSOR AND COMPUTER STAND ARE ON CASTERS AND MAY BE PUSHED IN CLOSER TO CENTER TO SAVE SPACE. ROOM SHOULD BE MAINTAINED TO PULL COMPUTER STAND OUT TO GAIN ACCESS TO THE BACK OF UNIT.

2 120VAC 20AMP CIRCUIT 1' ABOVE FLOOR.

3. NEED 3' SERVICE ACCESS IN REAR OF EQUIPMENT.

4. SIDE DOORS GO TO FULL HEIGHT OF TOWER. NEED 2' TO EITHER SIDE OF TOWER TO ALLOW DOORS TO OPEN FULLY.

